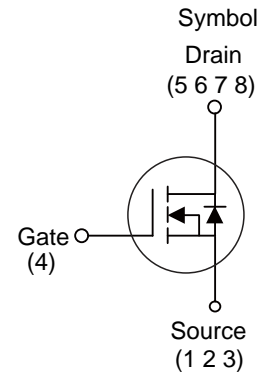

**PRODUCT CHARACTERISTICS**

$V_{DSS}$	20V
$R_{DS(ON)}$ Typ(@ $V_{GS}=4.5V$ )	10.5m $\Omega$
$R_{DS(ON)}$ Typ(@ $V_{GS}=2.5V$ )	12.5m $\Omega$
$I_D$	30A

**APPLICATIONS**

- \* Electronic lamp ballasts based on half bridge
- \* Load Switching, Quick/Wireless Charge.
- \* Motor Driving

**FEATURE**

- \* Low Gate Charge
- \* Pb-Free Lead Plating

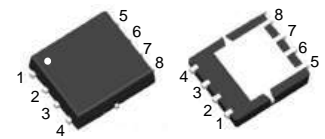

PDFN3X3

**ORDER INFORMATION**

Order Codes		Package	Packing
Halogen-Free	Halogen		
N/A	MOT2514J	PDFN3X3	5000 pieces/Reel

**ABSOLUTE MAXIMUM RATINGS**( $T_A=25^{\circ}C$ , unless otherwise specified)

Parameter	Symbol	Ratings	Unit
Drain-Source Voltage	$V_{DSS}$	20	V
Gate-Source Voltage	$V_{GSS}$	$\pm 12$	V
Drain Current Continuous(@ $V_{GS}=4.5V, T_A=25^{\circ}C$ )	$I_D$	30	A
Drain Current Continuous(@ $V_{GS}=4.5V, T_A=100^{\circ}C$ )	$I_D$	19	A
Drain Current Pulsed	$I_{DM}$	120	A
Avalanche Energy *	$E_{AS}$	49	mJ
Power Dissipation	$P_D$	45	W
Junction Temperature	$T_J$	+150	$^{\circ}C$
Storage Temperature	$T_{STG}$	-55~ +150	$^{\circ}C$

**THERMAL CHARACTERISTICS**

Parameter	Symbol	Typ	Unit
Junction to Case	$R_{thJC}$	2.78	$^{\circ}C/W$

 Note: \* EAS condition:  $T_J=25^{\circ}C, V_{DD}=12V, V_G=10V, L=0.5mH, R_g=25\Omega$

**■ ELECTRICAL CHARACTERISTICS** ( $T_C=25^{\circ}\text{C}$ , unless otherwise noted)

Parameter	Symbol	Test Conditions	Min	Typ	Max	Unit
Off characteristics						
Drain to Source Breakdown Voltage	$V_{DSS}$	$V_{GS}=0V, I_D=250\mu A$	20	-	-	V
Drain to Source Leakage Current	$I_{DSS}$	$V_{DS}=20V, V_{GS}=0V$	-	-	1	$\mu A$
Gate to Source Forward Leakage	$I_{GSS(F)}$	$V_{DS}=0V, V_{GS}=+12V$	-	-	100	nA
Gate to Source Reverse Leakage	$I_{GSS(R)}$	$V_{DS}=0V, V_{GS}=-12V$	-	-	-100	nA
On characteristics						
Drain to Source On-Resistance	$R_{DS(ON)}$	$V_{GS}=4.5V, I_D=15A$	-	10.5	14	$m\Omega$
		$V_{GS}=2.5V, I_D=10A$	-	12.5	16	$m\Omega$
Gate Threshold Voltage	$V_{GS(TH)}$	$V_{DS}=V_{GS}, I_D=250\mu A$	0.3	0.72	1.5	V
Dynamic characteristics						
Gate Resistance	$R_g$	$V_{GS}=0V, V_{DS}=0V, f=1.0MHz$	-	2.9	-	$\Omega$
Forward Transconductance	$g_{fs}$	$V_{DS}=10V, I_D=3A$	-	11	-	S
Input Capacitance	$C_{iss}$	$V_{DS}=12V, V_{GS}=0V$ $f=1.0MHz$	-	770	-	pF
Output Capacitance	$C_{oss}$		-	131	-	pF
Reverse Transfer Capacitance	$C_{rss}$		-	96	-	pF
Resistive Switching Characteristics						
Turn-on Delay Time	$t_{d(ON)}$	$V_{GS}=4.5V, V_{DS}=10V$ $I_D=15A, R_G=3\Omega$	-	6	-	ns
Rise Time	$t_r$		-	19	-	ns
Turn-off Delay Time	$t_{d(OFF)}$		-	30	-	ns
Fall Time	$t_f$		-	11	-	ns
Total Gate Charge	$Q_g$	$I_D=15A, V_{DS}=10V$ $V_{GS}=4.5V$	-	13	-	nC
Gate to Source Charge	$Q_{gs}$		-	2.5	-	nC
Gate to Drain("Miller") Charge	$Q_{gd}$		-	3.5	-	nC
Source-Drain Diode Characteristics						
Continuous Source Current(Body Diode)	$I_S$		-	-	30	A
Maximum Pulsed Current(Body Diode)	$I_{SM}$		-	-	120	A
Diode Forward Voltage	$V_{SD}$	$I_{SD}=3A, V_{GS}=0V$	-	0.73	1.2	V
Reverse Recovery Time	$t_{rr}$	$I_{SD}=15A, T_J=25^{\circ}\text{C}$ $di/dt=100A/\mu s$	-	7.5	-	ns
Reverse Recovery Charge	$Q_{rr}$		-	1.5	-	nC

■ TYPICAL CHARACTERISTICS

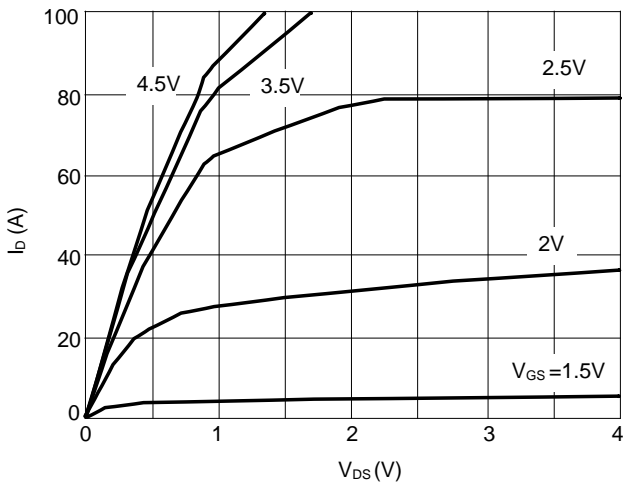

Figure 1: Output Characteristics

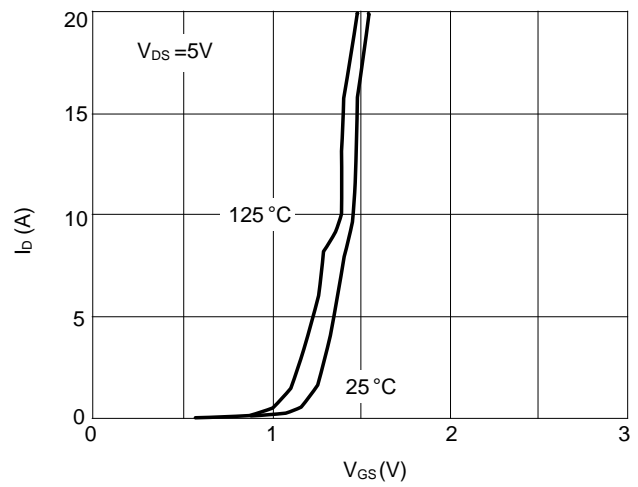

Figure 2: Typical Transfer Characteristics

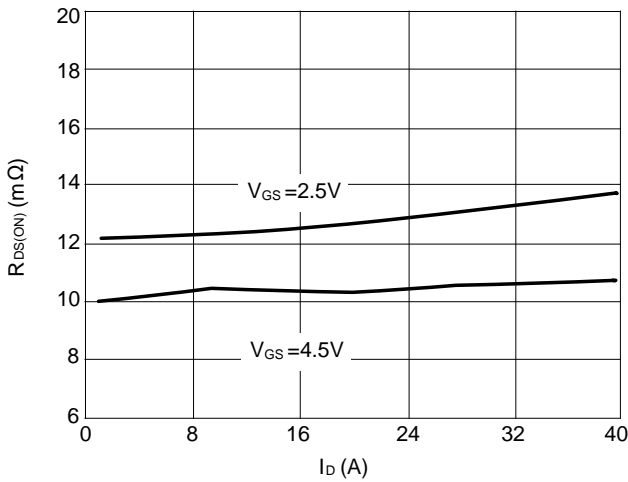

Figure 3: On-Resistance vs. Drain Current

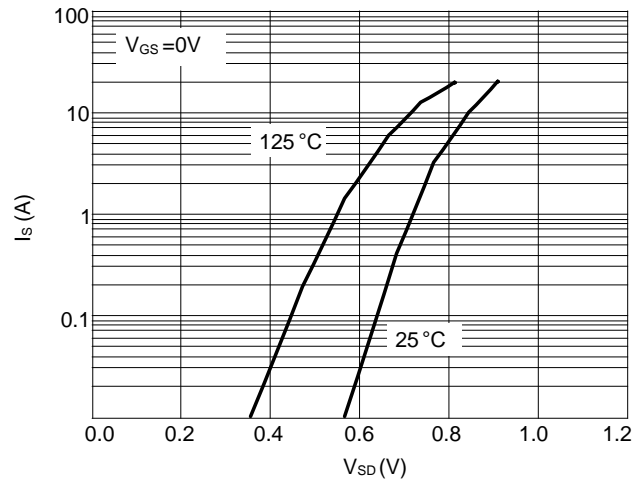

Figure 4: Body Diode Characteristics

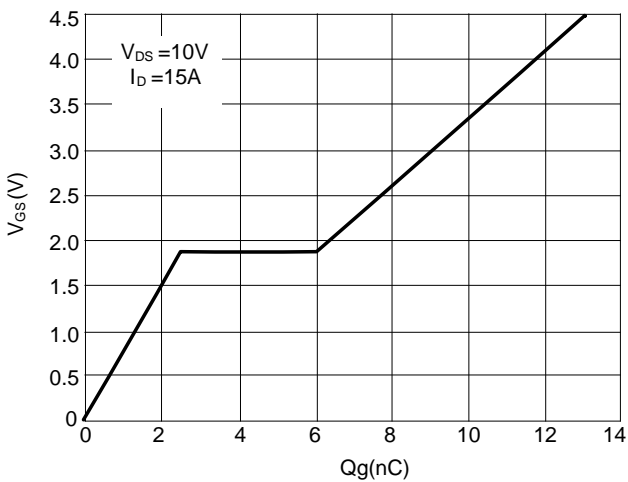

Figure 5: Gate Charge Characteristics

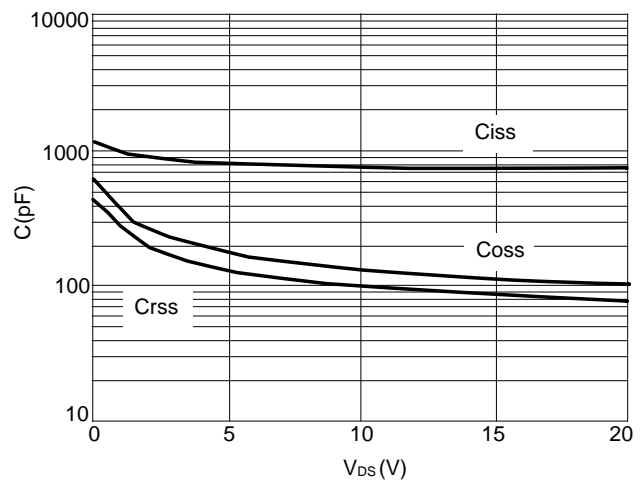

Figure 6: Capacitance Characteristics

■ TYPICAL CHARACTERISTICS(Cont.)

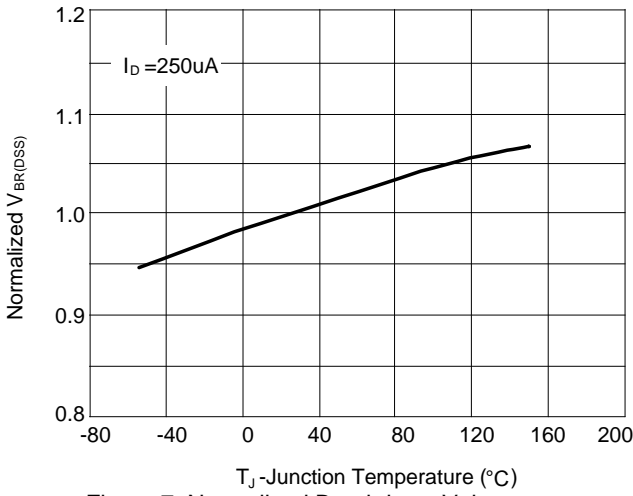

Figure 7: Normalized Breakdown Voltage vs. Junction Temperature

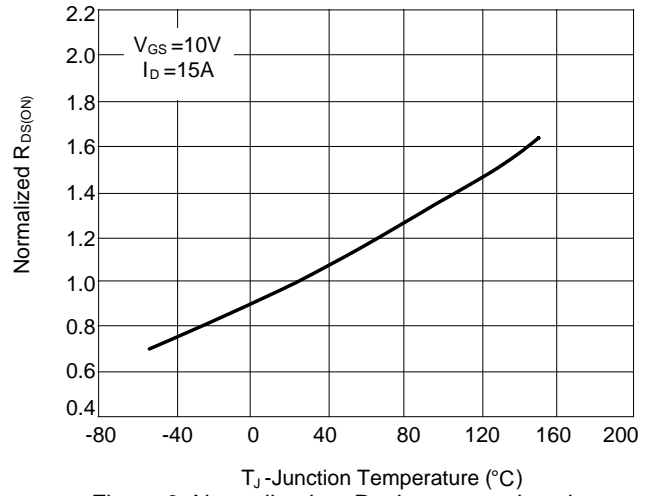

Figure 8: Normalized on Resistance vs. junction Temperature

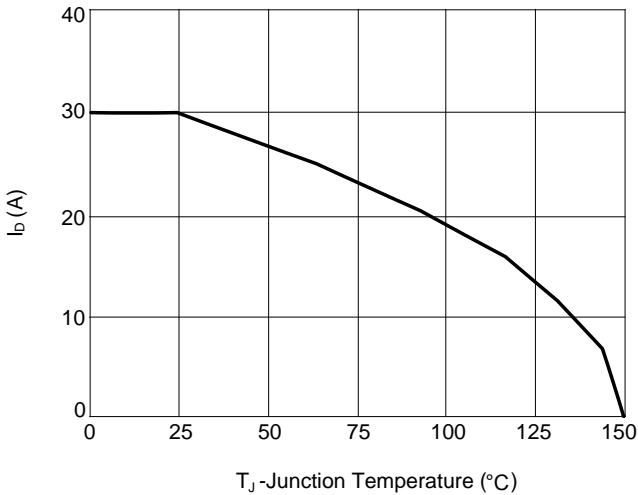

Figure 9: Maximum Continuous Drain Current vs. Case Temperature

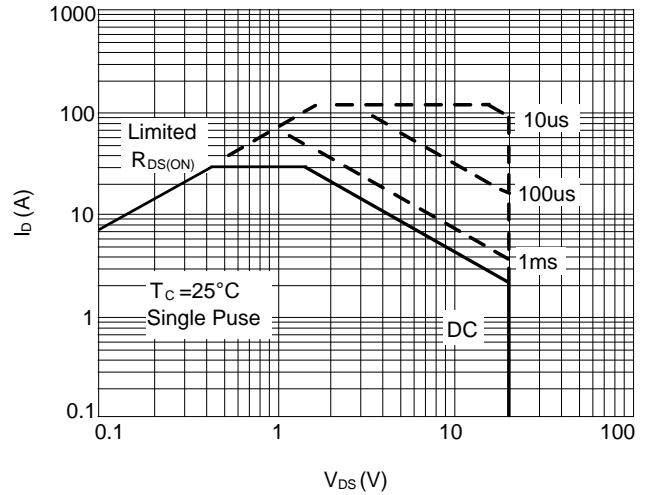
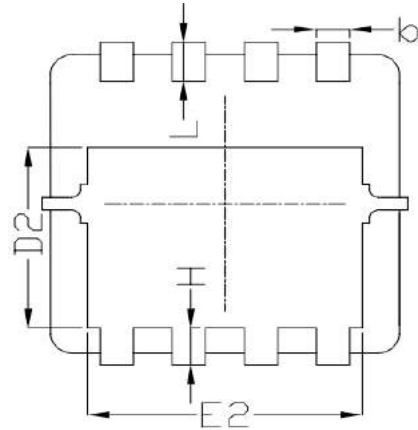
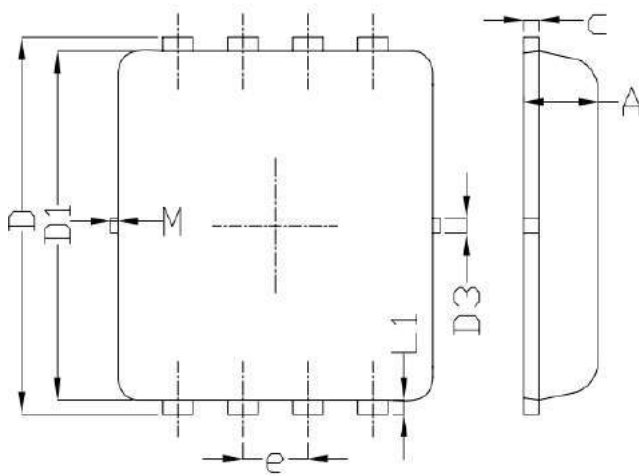
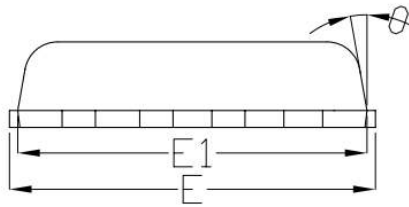

Figure 10: Maximum Safe Operating Area

■ PDFN3X3 PACKAGE OUTLINE DIMENSIONS



50



Land Pattern  
(Only for Reference)

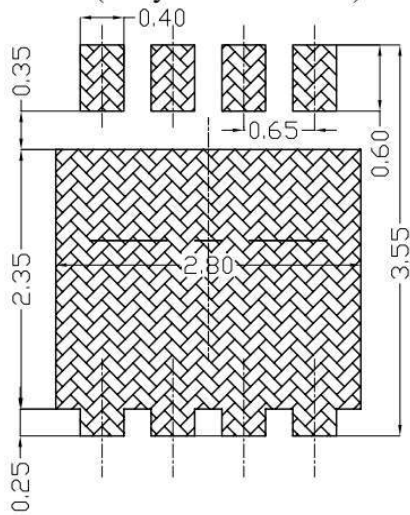

SYMBOL	DIMENSIONAL REQOMTS		
	MIN	NOM	MAX
A	0.70	0.75	0.80
b	0.25	0.30	0.35
c	0.10	0.15	0.25
D	3.25	3.35	3.45
D1	3.00	3.10	3.20
D2	1.78	1.88	1.98
D3	---	0.13	---
E	3.20	3.30	3.40
E1	3.00	3.15	3.20
E2	2.39	2.49	2.59
e	0.65BSC		
H	0.30	0.39	0.50
L	0.30	0.40	0.50
L1	---	0.13	---
θ	---	10°	12°
M	*	*	0.15
* Not specified			